

# TP 4

## TERRACE PEDESTAL



ArchiGreen Roof Ltd  
 3 Patzay Pal Utca • Gyor • H-9024  
 Website: www.archigreenroof.com  
 E-mail: info@archigreenroof.com

TP 4 is a black heavy-duty round-shaped screwjack pedestal, with height adjustability between 145 and 245 mm, adjustable millimetre by millimetre. It is made of UV-resistant copolymer polypropylene and is able to bear loads of up to 1000 kg / pedestal for the support of paving slabs and timber or timber composite decking on green roof terraces. Talc is also used in the production process to increase resistance to heat and acids. It comprises two elements:

- The Top with a diameter of 170 mm is designed to accommodate 4 tabs (tab width is either 2 or 4.5 mm) creating an open joint between paving slabs which is of particular importance on roof terraces where terrace tiles must be loose laid for proper drainage purposes.
- The Base with a diameter of 197 mm is designed to accommodate a slope corrector (TP-SC : 0 to 5%). The Top is screwed into the Base prior to delivery.

### Use

Usage of the TP 4 include:

- Constructing external raised floors between 145 and 245 mm
- Enhancing drainage properties (German FLL Guidelines)
- Coupled with the slope corrector TP-SC (+ 12 mm in height), the pedestal can be used for levelling uneven surfaces
- Versatility - the TP range is designed to accommodate various clips and spacers in accordance with the materials used by the manufacturers of terrace construction units

### Application area

TP 4 is designed to support roof terraces made of any kind of material: timber, composite wood, concrete, metal etc. where requested height varies between 145 and 245 mm. It can be placed on any kind of stable substrate and also over insulation panels. Coupled with the tabs on top, it can provide permanent spacing between the slabs to encourage better drainage.

Size (L x W x H )	Dia. 197 x 145 - 245 mm
Weight	0.690 kg / pedestal
Material	Copolymer Polypropylene (CPP) (80%) Talc + UV black masterbatch (20 %)
Material thickness	3 - 4.5 mm
Max. load capacity	1,000 kg
Temperature range	-30 °C to +90 °C
Performance	Resistant to UV light, climate changes, sea salt and almost all chemicals.
Ancillary parts	Tabs (2.5 or 4 mm in thickness) TP-SC slope corrector (0 to 5%)
Environmental aspect	Fully recyclable

### Installation example

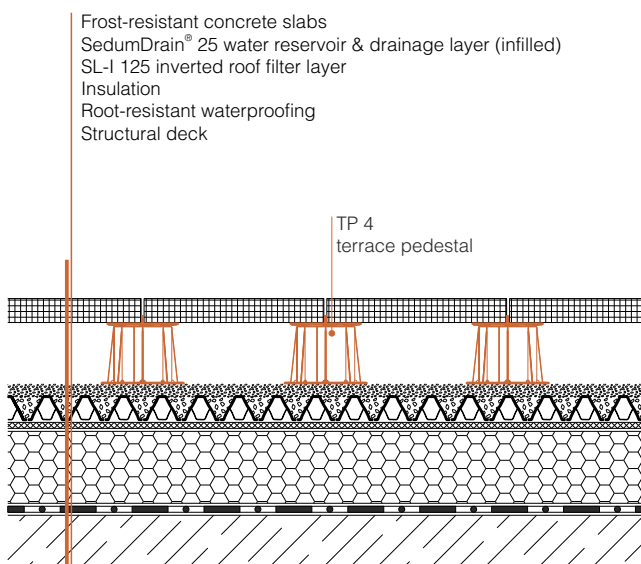

### Specification suggestion

ArchiGreen® TP 4 screwjack terrace pedestal is made of UV-resistant copolymer polypropylene (CPP) and talc and is black in colour. Specifically designed to support outdoor green roof terraces.

The TP 4 comprises two elements:

1. The Top (Ø 170 mm, surface area is 22,700 mm<sup>2</sup>) able to accommodate batten clips and spacers and consequently can provide permanent spacing between the slabs to facilitate drainage for terraces on building structures in accordance with German FLL Guidelines;
2. The Base (Ø 197 mm, surface area is 30,500 mm<sup>2</sup>) able to accommodate a slope corrector (TP-SC: 0 to 5%);

Height of pedestal: 145-245 mm. Weight: 0.690 kg/pedestal. Resistant to UV, climate changes, sea salt and almost all chemicals. Temperature range: -30 °C to +90 °C. Delivery and installation is in accordance with manufacturer's instructions.

### Technical illustration

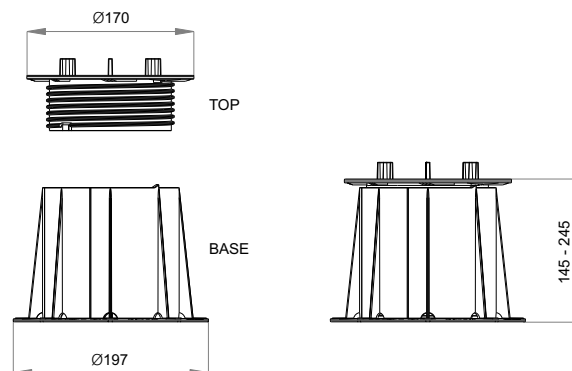

### Tools required

The required tools in this case vary according to the specified raised floor construction. However, a spirit level, tape measure and construction markers are most likely needed.

### Packaging unit

TP 4 (PB-4) can be despatched in corrugated boxes and on wooden pallets depending on the size of the order:

- 24 pedestals / box (600 x 400 x 600 mm, 18 kg)
- 15 boxes / pallet (1200 x 1000 x 2000 mm, 285 kg)